



AT10 & AT10 ANC True Wireless Earbuds

User Manual

Legal Notice

This document is created by ALE China Co. Ltd. (hereinafter referred to as "ALE China"). Anyone who accesses and uses this document shall agree to comply with the following clauses. If you do not agree to comply with these clauses, please do not use this document. ALE China reserves the right to update, correct and modify the following clauses at any time without notice, and these updates will also be binding on you.

Trademark Notice

The Alcatel-Lucent name and logo are trademarks of Nokia used under license by ALE China.

Copyright Notice

The copyright of any content (including but not limited to data, text, graphics, images, sound or video, etc.) provided in this document belongs to ALE China. You may not copy, reproduce, transmit, publish, repost, adapt or display the content of this document in any way without the prior written permission of ALE China. Any unauthorized use of this document will violate the Copyright Law of the People's Republic of China and other laws and regulations as well as the provisions of relevant international conventions.

Disclaimer

While efforts were made to verify the completeness and accuracy of the information contained in this documentation, this document is provided "as is". To get more accurate content concerning Cross Compatibilities, Product Limits, Software Policy and Feature Lists, please refer to the accurate documents published on the Business Partner Web Site.

In the interest of continued product development, ALE China reserves the right to make improvements to this documentation and the products it describes at any time, without notice or obligation.

The user shall be solely liable for any loss or damage (including direct, indirect, special or consequential loss or damage) arising from the use of the information contained herein for any reason whatsoever.

To the extent permitted by law, ALE China reserves the right of final interpretation.

This document is only authorized to be used under the purpose of performing the contract obligations under the relevant contract signed with ALE China and shall not be used for other purposes.

Content

1. Introduction	4
2. Product overview	5
3. Accessories	6
4. Connection	7
5. Wearing the earbuds	8
5.1 Changing the ear gels	8
6. Charging	9
7. Using the headset	10
7.1 Turning on/off the earbuds	10
7.2 Music mode	10
7.3 Call handling	11
7.3.1 Answering/ending/rejecting a call	11
7.3.2 Muting/unmuting the microphone during a call.....	11
7.3.3 Handling multiple calls	11
7.4 Settings	12
7.4.1 (For AT10 ANC) ANC Mode & Transparency Mode.....	12
7.4.2 Pairing mode	12
7.4.3 Factory reset	12
8. Power indicator	13
9. Firmware update	15
10. Maintenance	17
11. Warning	18

1. Introduction

Thank you for purchasing the Alcatel-Lucent Enterprise AT10 or AT10 ANC True Wireless Earbuds. We hope you enjoy it.

This User Manual will get you started and help you make the most of your headset.

Features

- Extraordinary call noise reduction with ENC for you to have effortlessly clear calls even in noisy environments
- Active Noise Cancellation (ANC) Mode and Transparency Mode (for AT10 ANC)
- Long battery life: 6 hours on a single charge + 3 additional charges via the charging case (The single earbud mode lets you use the earbuds continuously for up to 48 hours. This is possible by alternating the usage and recharge of each earbud.)
- Convenient mute control
- Work well with mainstream Unified Communications (UC) platforms and deskphones
- Plug-and-play Bluetooth dongle for easier connection

2. Product overview

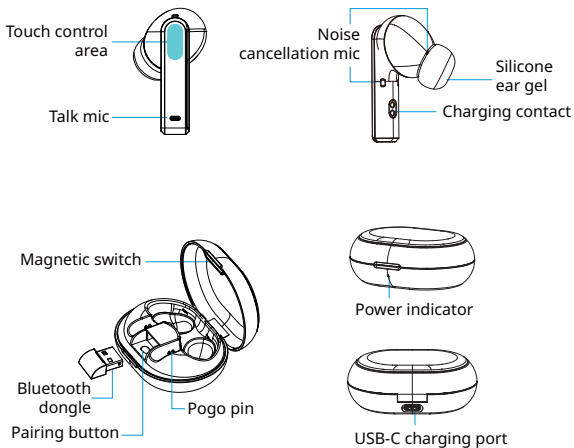

3. Accessories

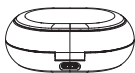

Charging case



USB-A to USB-C
charge cable

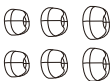

3 pairs of ear gels
(S/M/L)



USB-A Bluetooth dongle

Note: The actual colors and dimensions may differ from the images.

4. Connection

Connecting AT10/AT10 ANC to your PC, deskphone or smartphone/tablet

- Bluetooth dongle

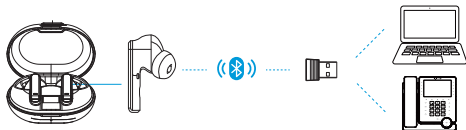

The earbuds and the Bluetooth dongle are supplied pre-paired and ready for use.

Step 1: Open the lid of the charging case and take the earbuds out.

Step 2: Take the Bluetooth dongle out and plug it into your device (PC or deskphone).

Step 3: The earbuds automatically connect to your device without the need to install any software.

- Bluetooth

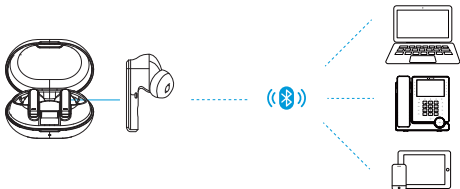

Step 1: Open the lid of the charging case and take the earbuds out of the case.

Step 2: Use one of the two methods below.

- Wait for the earbuds to connect to a previously connected Bluetooth device within 15s. If the connection is not successful, the earbuds enter pairing mode.

- Rather than waiting for about 15s, you could directly long press the pairing button for 2s to make the earbuds enter pairing mode.

Step 3: Turn on Bluetooth on your device (PC, deskphone, smartphone or tablet) and select AT10 (or AT10 ANC) in your device's Bluetooth device list for pairing.

5. Wearing the earbuds



Put the earbuds into your ear canal. Adjust the earbuds by rotating them to fit your ears. Point the front of the microphone toward your mouth.

5.1 Changing the ear gels

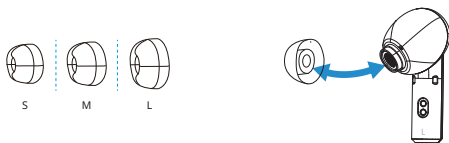

Choose the best ear gel size. Your ear gels should make a good seal with your ear canal. When the fit is right, you will have a better noise cancellation experience. Your AT10 (or AT10 ANC) come with three sizes of ear gels. The medium size comes already attached.



6. Charging

The earbuds have up to 6 hours of listening time with 18 additional hours provided by its pocket-sized charging case, giving you up to 24 hours of combined playback. The independent single-bud use feature allows you to enjoy extended battery life.

- Earbuds

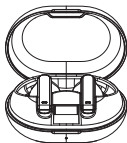

Put the earbuds into the charging case. They will automatically begin to charge.

It takes approximately 1.5 hours to fully charge the earbuds. Charging in the case for around 20 minutes will provide about 1 hour of battery life.

- Charging case

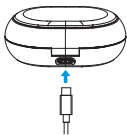

Connect the charging case to a compatible USB power source or wall charger via the USB-A to USB-C charge cable provided. It takes approximately 1.5 hours to fully charge the earbuds and the charging case.

Note: The charging box is designed to use standard USB 5V voltage for charging. Higher voltage charging is not recommended.

Warning: Use a charger that has been approved by relevant authorities, and complies with device electrical parameters and local laws and regulations. Otherwise, fire, explosion and other hazards may occur.

7. Using the earbuds

7.1 Turning on/off the earbuds

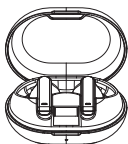

Turn on

Open the lid of the charging case. The earbuds will turn on automatically.

Turn off

- Put the earbuds back into the charging case to turn off automatically.
- Turn off Bluetooth on your device. The earbuds will automatically turn off when they are disconnected from your device for more than 5 minutes.
- The earbuds will automatically power off in case they fail to re-establish a connection to a new device after getting disconnected due to being out of range. To be more precise, the earbuds will enter pairing mode if they are not reconnected within 10 minutes. In pairing mode, the earbuds will automatically turn off after 5 minutes if no device is paired.

7.2 Music mode

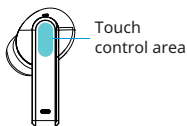

- Play/Pause music:** Tap once
- Next track:** Tap twice
- Previous track:** Tap three times



7.3 Call handling

7.3.1 Answering/ending/rejecting a call

When there is an incoming call, you can:

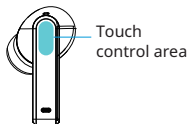

- **answer/end a call:** Tap twice
- **reject a call:** Hold for 2 seconds

7.3.2 Muting/unmuting the microphone during a call

During a call, you can:

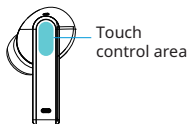

- **mute/unmute the microphone:**
Tap once

7.3.3 Handling multiple calls

When there are multiple incoming calls, you can:

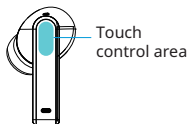

- **end the current call to accept the incoming one:** Tap twice
- **put the current call on hold and answer the incoming one/end the incoming call and resume the call on hold:** Tap three times
- **reject the incoming call:** Hold for 2 seconds



7.4 Settings

7.4.1 (For AT10 ANC) ANC Mode & Transparency Mode

You can control the ANC Mode and switch to the Transparency Mode via the touch control area. In the Transparency Mode, you can hear the world around you without taking off your earbuds.

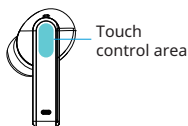

**ANC Mode on/ANC Mode off/
Transparency Mode:** Hold for 2
seconds

7.4.2 Pairing mode

You can make the earbuds enter pairing mode via the pairing button.

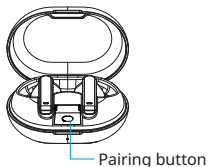

• **Enter pairing mode:** Hold for 2
seconds

7.4.3 Factory reset

You can factory reset the earbuds via the pairing button. This operation resets all the device settings to the factory defaults and deletes all pairing information.

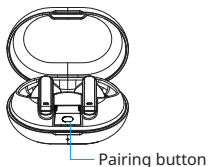

• **Factory reset the earbuds:** Hold for
10 seconds

8. Power indicator

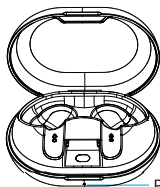

Power indicator



Full charge



Charging above 70%



Charging 30%~70%



Charging 10%~30%



Charging less than 10%

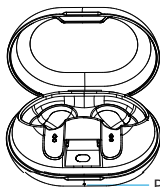

Power indicator



Open/close the lid | On for 3s*



Put the earbuds back into the charging case | On for 1s*



Enter pairing mode | Flashing for 8s



Factory reset the earbuds | Flashing alternately for 3s

* The light color depends on the battery level.

9. Firmware update

The ALE Go app helps you boost your headset performance through regular firmware updates.

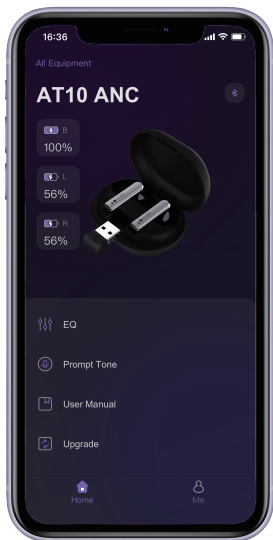

Download ALE Go to stay tuned for the latest firmware updates available.

- Select an EQ mode
- Customize the prompt language
- View the User Manual
- Perform firmware upgrades



10. Maintenance

- Please store your earbuds in the charging case that it came in when not in use.
- To prevent battery depletion, please avoid storing your headset in a too hot or too cold environment (e.g. in the car in summer or winter).
- It is recommended to keep the earbuds at a temperature between -10°C and 30°C (50°F and 86°F).
- Do not store the earbuds for long periods of time without charging. It is advisable to charge the earbuds at least once every 3 months to avoid damaging the battery.
- Clean your earbuds regularly to prevent earwax from building up on your earbuds.

11. Warning



Do not listen at high volume levels for long periods.

AT10 & AT10 ANC True Wireless Earbuds

User Manual

www.aledevice.com

